

RemoteApps Prerequisites:

1. An Internet Connection
2. An Allina Login ID and Allina Login Password
3. An RSA security token
4. You must have the necessary Citrix Web Client Software installed or have the privileges to install software.

RemoteApps from a Windows Computer

1. Ensure your internet connection is active.
2. Open up Microsoft Internet Explorer and type the following in the address field: <http://www.allina.com/remotapps>. Press the “Enter” key or click the “Go” button next to the address field.
3. This will bring up the Allina Remote Applications Login screen. If you do NOT have the required client software installed you will see the section circled below:

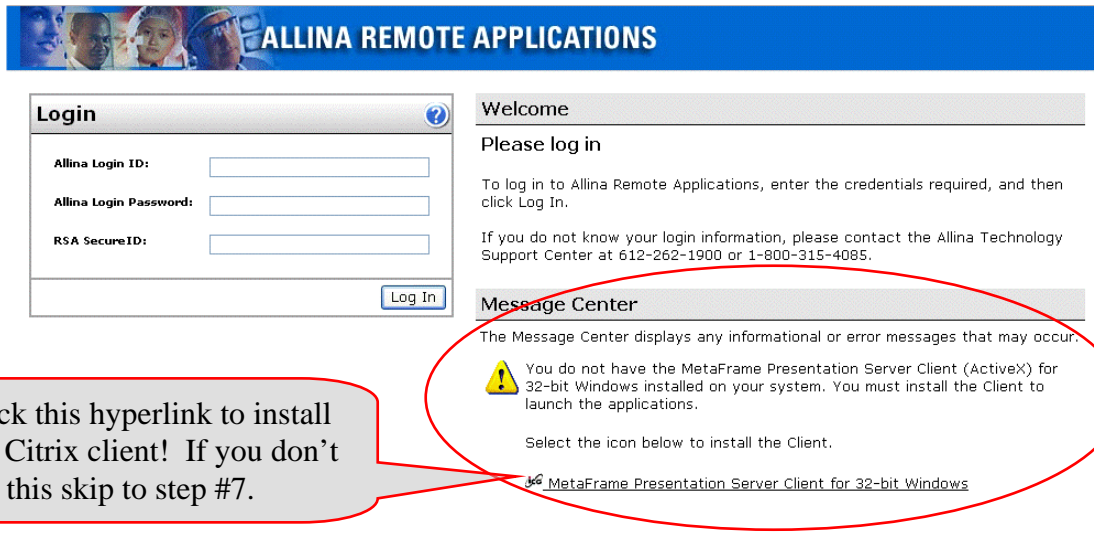

4. Click on the hyperlink indicated in the above image to initiate the Citrix Web Client installation process. You will then see some or all of the following dialog boxes open as part of this process.

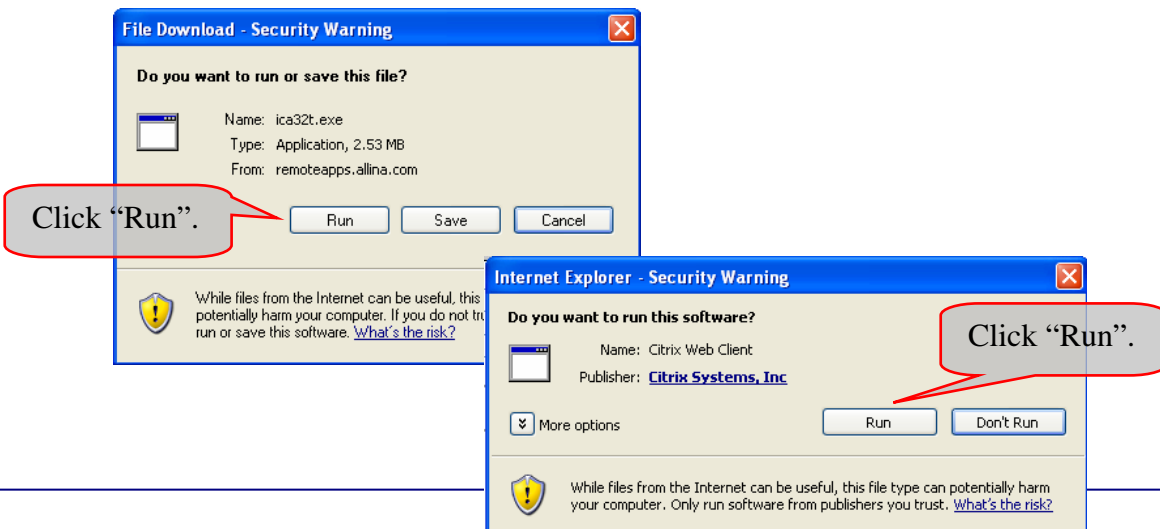

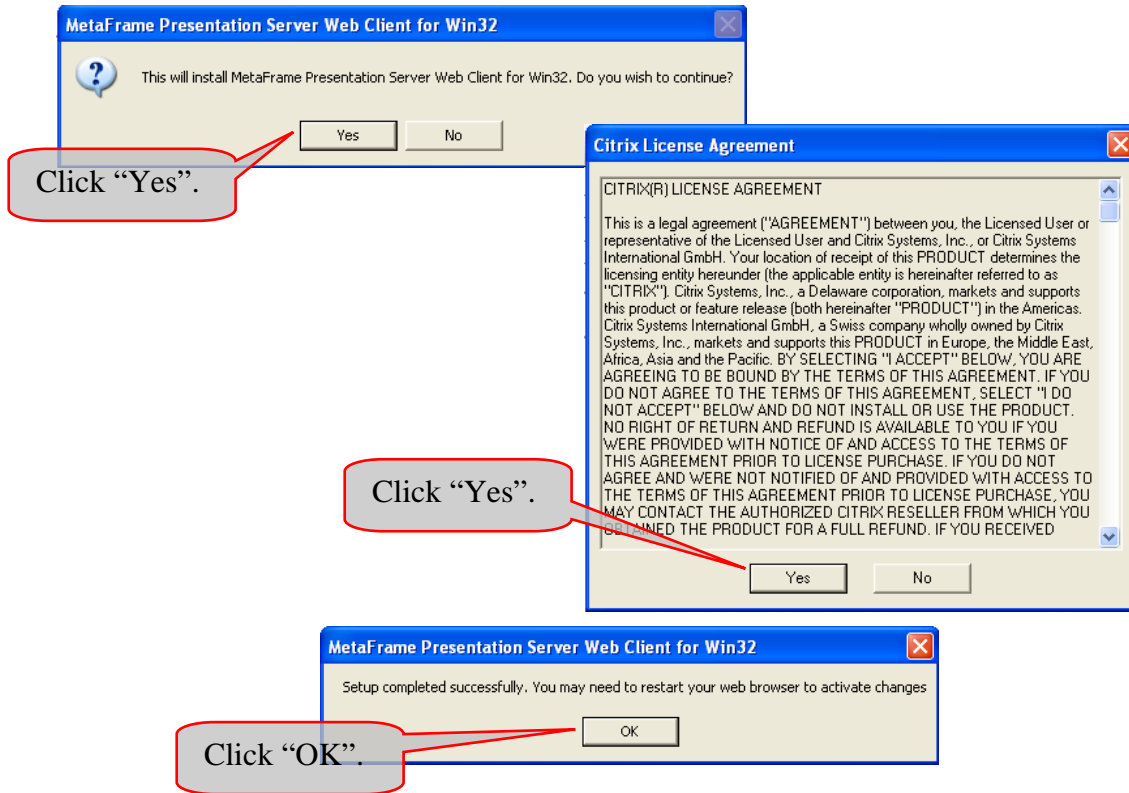

5. When you have reached the final dialog box and have clicked 'OK' you should then close the Internet Explorer window you have opened to RemoteApps. You should also close any other Internet Explorer windows you may have open.
6. Open up Microsoft Internet Explorer and type the following in the address field: <http://www.allina.com/remoteapps>. Press the "Enter" key or click the "Go" button next to the address field.
7. If the Citrix Web Client installation was successful you should no longer see the warning message and hyperlink to install a new client but it should look instead like the image below:

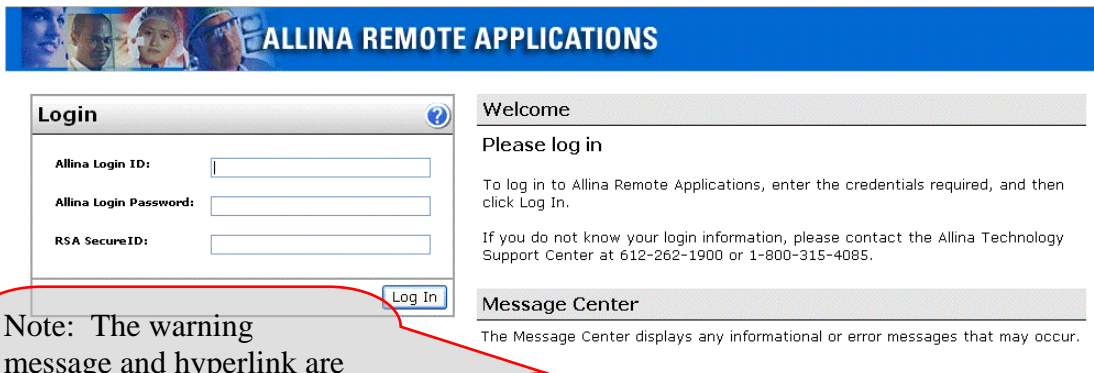

Note: The warning message and hyperlink are gone. This indicates the Citrix Web Client is already installed on your computer.

8. Login with your Allina Login ID, Allina Login Password, and the RSA SecureID on your security token.

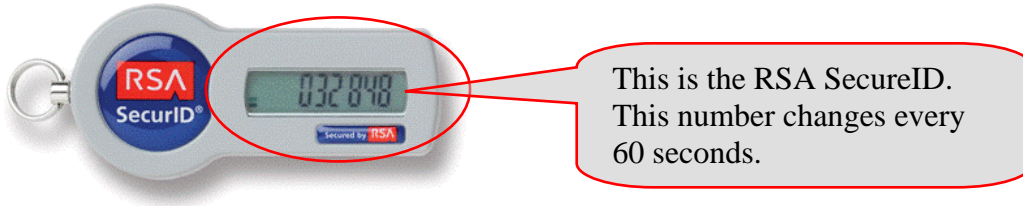

9. After you have successfully logged in you will see the Applications section below. You may now click on one of the Applications Folders as shown below (Note: you may not see all the folders, depending on the privileges you have been granted):

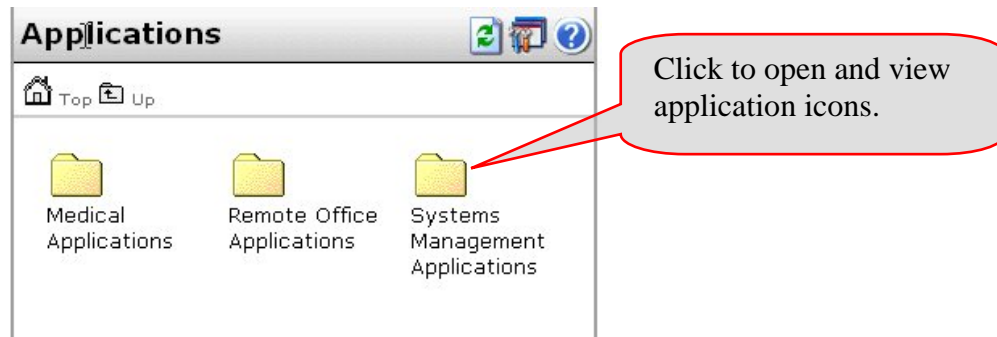

10. Next click on the application icon. If you need to navigate back to the main folders use the “Top” and “Up” icons at the top-left corner of this window.

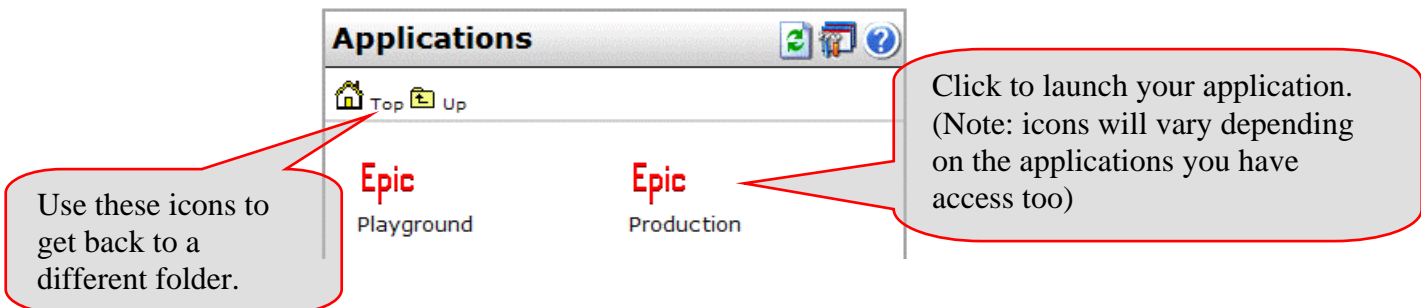

11. The first time you connect to an application via Citrix you may be presented with the following security screen. Please select the settings as shown in the diagram and then select OK. This should not show again.

